

NOTE: DO NOT DISCARD the Parts List from the Instruction Bulletin. Place the Parts List in the appropriate place in the machine manual for future reference. Retaining the Parts List will make it easier to reorder individual parts and will save the cost of ordering an entire kit.

NOTE: Numbers in parenthesis () are reference numbers for parts listed in Bill of Materials.

Installation instructions for **kit number 9015050**

SYNOPSIS:

This kit contains the parts needed to replace the power steering controller on M17 sweeper-scrubbers and T17 scrubbers.

Please follow step-by-step instructions.

SPECIAL TOOLS / CONSIDERATIONS: NONE

(Estimated time to complete: 45 minutes)

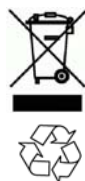

PROTECT THE ENVIRONMENT

Please dispose of packaging materials, used machine components such as batteries and fluids in an environmentally safe way according to local waste disposal regulations.

Always remember to recycle.

PREPARATION:

FOR SAFETY: Before leaving or servicing machine, stop on level surface, turn off machine, and remove key.

1. Disconnect the battery cable from the machine.



WARNING: Always disconnect battery cables from machine before working on electrical components.

2. Remove the access panel from the machine. Set the access panel and all hardware aside. (Fig. 1)



FIG. 1

INSTALLATION:

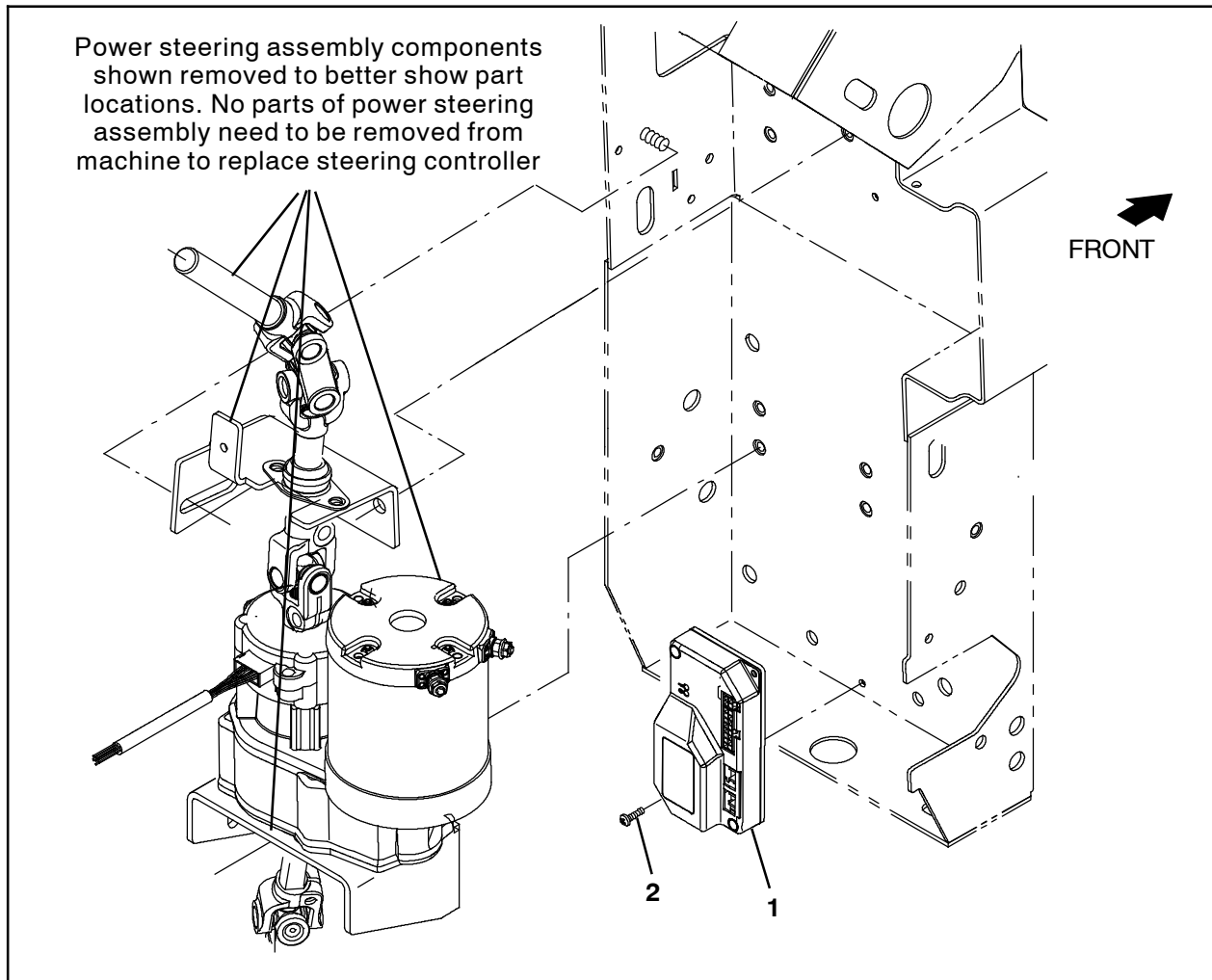

FIG. 2

1. Disconnect all the power steering harness connections from the steering controller. (Fig. 3 / Fig. 4)

2. Remove the steering controller from the machine. Discard the removed steering controller and all mounting hardware. (Fig. 2)

3. Use two M4 pan screws (2) to install the new steering controller (1) onto the machine. (Fig. 2)

4. Connect the power steering harness to the steering controller (1). (Fig. 2 / Fig. 3 / Fig. 4)

5. Reconnect the battery cable to the machine.

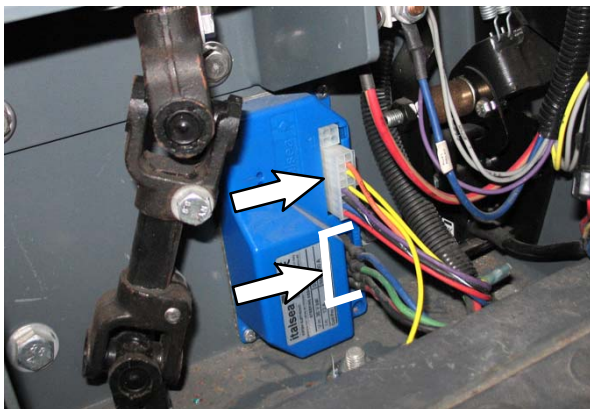

FIG. 3

6. **Calibration:** Connect power steering wire harness YEL- 1 wire and YEL- 2 wire located near the controller to the switch (4). (Fig. 4 / Fig. 5 / Fig. 6)

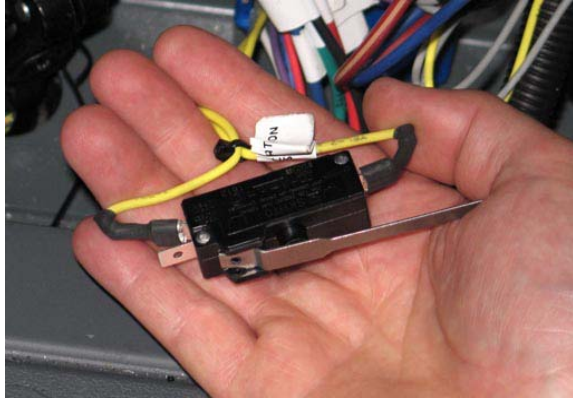

FIG. 5

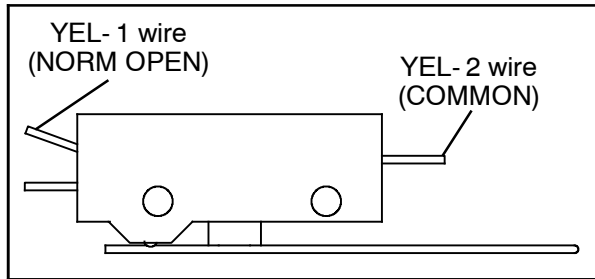

FIG. 6

7. **Calibration:** Ensure the steering wheel is loose with slight play in both directions (no load in either direction).
8. **Calibration:** Turn the key to the ON position.
9. **Calibration:** Turn OFF all machine functions and options. All functions / options (spray nozzle, lights, etc...) must be OFF when the power steering motor (1) is calibrated. The power steering motor will not calibrate if functions / options are on.

10. **Calibration:** Quickly squeeze / activate the switch (3) lever four times within 3 seconds. The power steering controller (1) LED will illuminate each time the snap switch lever is squeezed. The LED will remain illuminated for 2 seconds the fourth time the snap switch lever is squeezed to show the sequence is completed. (Fig. 7)

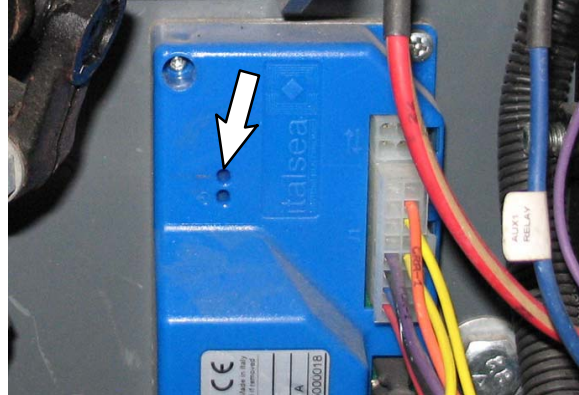

FIG. 7

11. Test the machine. Turn the steering wheel in the complete range of motion in both directions. The machine should steer smoothly and with the same amount of resistance in both directions. Recenter the steering wheel and repeat calibration if the steering is not functioning smoothly with the same amount of resistance when turned in either direction. Do not turn on any machine functions / options when testing the machine.

NOTE: To complete calibration, all functions and options must remain OFF until after the key is turned to the OFF position.

12. **Calibration:** Turn the key to the OFF position.
13. **Calibration:** Disconnect the power steering wire harness YEL- 1 wire and YEL- 2 wire from the snap switch (3). (Fig. 4 / Fig. 5 / Fig. 6)
14. Reinstall the access panel onto the machine.

Bill Of Materials For Controller Kit, Steering, Afmkt [T17/M17] - 9015050

Ref.	Tennant Part No.	Description	Qty.
1	1217792	Controller, Steering, 36V	1
2	06927	Screw, Pan, Phl, M4 X 0.70 X 16, 4.8	2
3	9015050	Switch, Snap, 25A SPDT	1

TENNANT COMPANY
P. O. Box 1452
Minneapolis, MN 55440-1452